

Reducing inserts

With hexagon for locking
 Tube socket pre-assembled

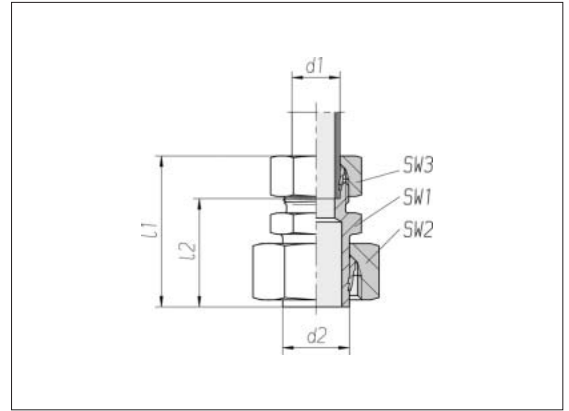

| Tube socket d2 | Pressure | Series Tube OD d1 | SW1 | SW2 | SW3 | l1 approx. | l2 | kg/100 approx. | Order No. Single component | Order No. * |
|-------------------|----------|-------------------------|-----|-----|-----|---------------|------|-------------------|-------------------------------|-----------------|
| L 35 | PN 160 | L 28 | 41 | 50 | 41 | 61.5 | 45 | 31.8 | 0 1 48 40 20 74 | 0 1 48 40 20 73 |
| L 35 | PN 160 | L 22 | 36 | 50 | 36 | 60.5 | 44 | 28.8 | 0 1 48 41 20 74 | 0 1 48 41 20 73 |
| L 35 | PN 160 | L 18 | 36 | 50 | 32 | 58.5 | 42 | 28.7 | 0 1 48 42 20 74 | 0 1 48 42 20 73 |
| L 35 | PN 160 | L 15 | 36 | 50 | 27 | 56.5 | 41.5 | 29.1 | 0 1 48 43 20 74 | 0 1 48 43 20 73 |
| L 35 | PN 160 | L 12 | 36 | 50 | 22 | 55 | 40.5 | 28.6 | 0 1 48 44 20 74 | 0 1 48 44 20 73 |
| L 42 | PN 160 | L 35 | 46 | 60 | 50 | 69 | 47.5 | 47.8 | 0 1 48 45 20 74 | 0 1 48 45 20 73 |
| L 42 | PN 160 | L 28 | 46 | 60 | 41 | 64 | 47.5 | 45.1 | 0 1 48 46 20 74 | 0 1 48 46 20 73 |
| L 42 | PN 160 | L 22 | 46 | 60 | 36 | 63 | 46.5 | 44.9 | 0 1 48 47 20 74 | 0 1 48 47 20 73 |
| L 42 | PN 160 | L 18 | 46 | 60 | 32 | 61 | 44.5 | 46.2 | 0 1 48 48 20 74 | 0 1 48 48 20 73 |
| L 42 | PN 160 | L 15 | 46 | 60 | 27 | 60 | 45 | 45.0 | 0 1 48 49 20 74 | 0 1 48 49 20 73 |
| L 42 | PN 160 | L 10 | 46 | 60 | 19 | 59 | 44 | 44.2 | 0 1 99 80 20 74 | 0 1 99 80 20 73 |

Other diameter combinations
 on request

* With union nut and 2S cutting ring