

## Reducing inserts

With hexagon for locking  
Tube socket pre-assembled

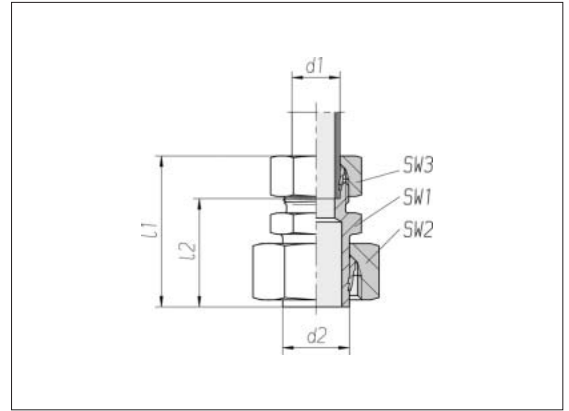

Tube socket d2	Pressure	Series Tube OD d1	SW1	SW2	SW3	l1 approx.	l2	kg/100 approx.	Order No. Single component	Order No. *
S 25	PN 400	S 20	32	46	36	70	48.5	37.0	0 1 48 85 20 74	0 1 48 85 20 73
S 25	PN 400	S 16	27	46	30	65	46.5	33.2	0 1 48 86 20 74	0 1 48 86 20 73
S 25	PN 400	S 14	27	46	27	65	47	33.1	0 1 48 87 20 74	0 1 48 87 20 73
S 25	PN 400	S 12	27	46	24	62	45.5	32.6	0 1 48 88 20 74	0 1 48 88 20 73
S 25	PN 400	S 10	27	46	22	60	43.5	31.9	0 1 48 89 20 74	0 1 48 89 20 73
S 25	PN 400	S 8	27	46	19	59	44	31.5	0 1 99 00 20 74	0 1 99 00 20 73
S 25	PN 160	L 22	32	46	36	64	47.5	36.0	0 1 98 37 20 74	0 1 98 37 20 73
S 25	PN 315	L 18	27	46	32	60	43.5	31.7	0 1 98 62 20 74	0 1 98 62 20 73
S 30	PN 400	S 25	41	50	46	78	54	49.4	0 1 48 90 20 74	0 1 48 90 20 73
S 30	PN 400	S 20	32	50	36	73	51.5	39.9	0 1 48 91 20 74	0 1 48 91 20 73
S 30	PN 400	S 16	32	50	30	68	49.5	37.9	0 1 48 92 20 74	0 1 48 92 20 73
S 30	PN 400	S 14	32	50	27	68	50	18.1	0 1 48 93 20 74	0 1 48 93 20 73
S 30	PN 400	S 12	32	50	24	65	48.5	37.5	0 1 48 94 20 74	0 1 48 94 20 73
S 38	PN 315	S 30	46	60	50	87	60.5	71.4	0 1 48 95 20 74	0 1 48 95 20 73
S 38	PN 315	S 25	41	60	46	84	60	64.5	0 1 48 96 20 74	0 1 48 96 20 73
S 38	PN 315	S 20	41	60	36	79	57.5	60.5	0 1 48 97 20 74	0 1 48 97 20 73
S 38	PN 315	S 16	41	60	30	74	55.5	58.9	0 1 48 98 20 74	0 1 48 98 20 73
S 38	PN 315	S 10	41	60	22	71	54.5	28.2	0 1 99 87 20 74	0 1 99 87 20 73

Other diameter combinations  
on request

\* With union nut and 2S cutting ring