

Adjustable elbow couplings with lock nut

Thread:
Whitworth pipe thread,
straight

Sealed with PEFLEX seal

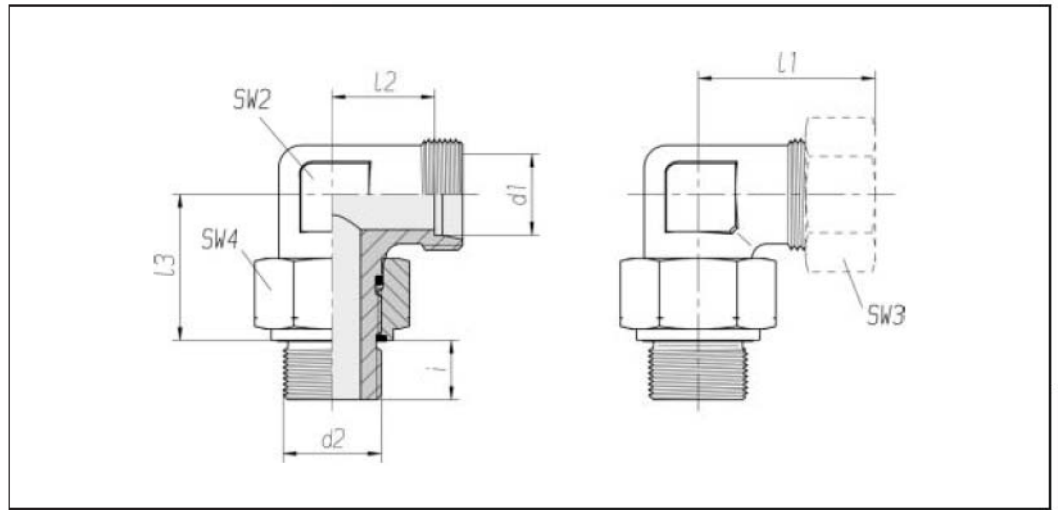

Series	Pressure	d2		SW2	SW3	SW4	l1*	l2	l3	i	kg/100 approx.	Order No. Single component	Order No. **
Tube OD		d1					approx.						
S 6	PN 315	G 1/4 A		17	17	19	33	18	26	12	8.7	1 1 44 50 20 81	1 1 44 50 20 XX
S 8	PN 315	G 1/4 A		17	19	19	33	18	26	12	8.5	1 1 44 55 20 81	1 1 44 55 20 XX
S 10	PN 315	G 3/8 A		19	22	22	36	19.5	29	12	12.1	1 1 44 60 20 81	1 1 44 60 20 XX
S 12	PN 315	G 3/8 A		19	24	22	38	21.5	29	12	12.1	1 1 44 65 20 81	1 1 44 65 20 XX
S 14	PN 315	G 1/2 A		22	27	27	40	22	30	14	19.3	1 1 44 70 20 81	1 1 44 70 20 XX
S 16	PN 315	G 1/2 A		27	30	27	45	26.5	37	14	27.3	1 1 44 75 20 81	1 1 44 75 20 XX
S 16	PN 250	G 3/4 A		27	30	36	45	26.5	39	16	35.3	1 1 44 76 20 81	1 1 44 76 20 XX
S 20	PN 250	G 3/4 A		27	36	36	49	27.5	39	16	36.2	1 1 44 80 20 81	1 1 44 80 20 XX
S 25	PN 250	G 1 A		41	46	41	56	32	50.5	18	75.0	1 1 44 85 20 81	1 1 44 85 20 XX
S 25	PN 250	G 3/4 A		36	46	36	54	30	44.5	16	46.5	1 1 44 86 20 81	1 1 44 86 20 XX
S 30	PN 160	G 1 1/4 A		50	50	50	87	36.5	56	20	118.7	1 1 44 90 20 81	1 1 44 90 20 XX
S 38	PN 160	G 1 1/2 A		50	60	55	72	41	57.5	22	129.5	1 1 44 95 20 81	1 1 44 95 20 XX

Supplementary to Order No. for complete fitting

tube connection

Supplementary to Order No.

2S

07

ES-4

09

BV-10

Refer to the front page

* Apply to complete fittings with 2S or ES-4 tube connection components.
For BV-10 Refer to the front page.

** With union nut and 2S, ES-4 or BV-10 tube connection components